

F

E

D

C

B

A

ZONE	SYMBOL	REVISION	APPROVAL	DATE

RoHS
Compliant

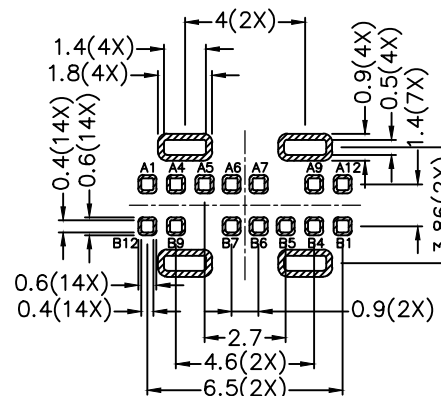
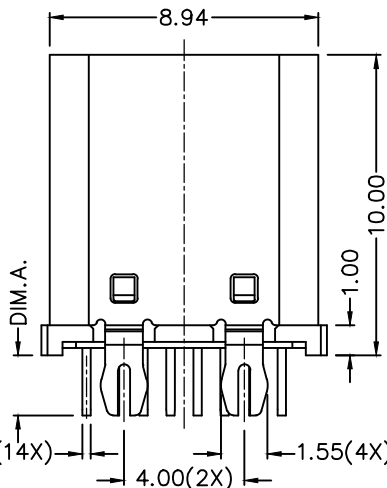
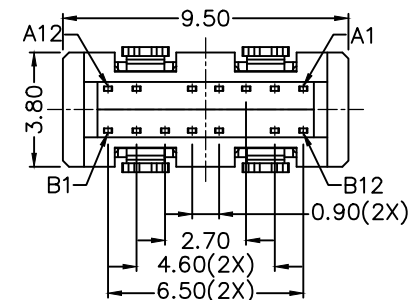
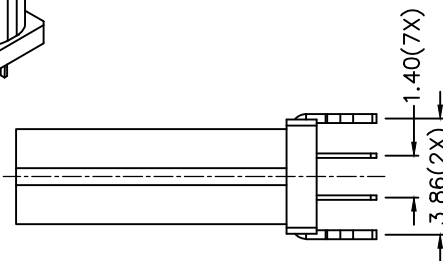
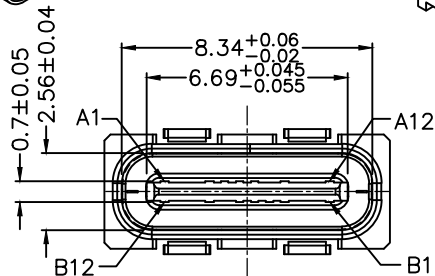
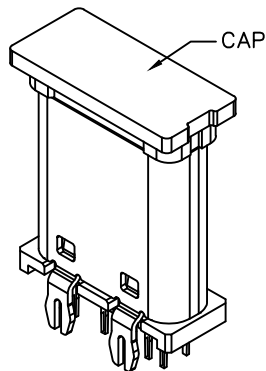
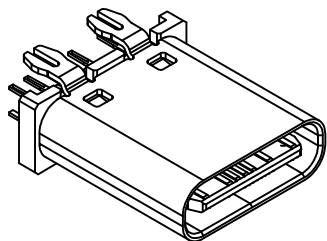

RECOMMENDED PCB LAYOUT
TOLERANCE: ±0.05
(TOP VIEW)

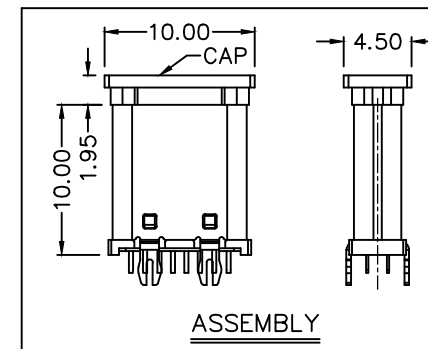

ASSEMBLY

PIN ASSIGNMENT (FRONT VIEW)

PIN NO.	A1	A2	A3	A4	A5	A6	A7	A8	A9	A10	A11	A12
	GND			Vbus	CC1	D+	D-		Vbus			GND
	GND			Vbus		D-	D+	CC2	Vbus			GND
PIN NO.	B12	B11	B10	B9	B8	B7	B6	B5	B4	B3	B2	B1

MODEL NO.	LUB-C131-0	LUB-C131-1
DIM.A.	2.00(14X)	1.20(14X)

DESCRIPTION	MATERIAL	PLATING
CONTACT	COPPER ALLOY	NICKEL PLATED ON ALL AREA, Au 1u" MIN ON CONTACT AREA, Tin PLATED ON SOLDER AREA.
SHELL	STAINLESS STEEL	NICKEL(Ni)
MIDDLE PLATE	STAINLESS STEEL	
INSULATOR	HIGH TEMP. PLASTIC	COLOR:BLACK
CAP	HIGH TEMP. PLASTIC	COLOR:BLACK



LINKPLEX TECHNOLOGY LIMITED

DESIGN	H.L.TAN	DATE	21-7-2022	SCALE	4:1
DRAWING	J.Q.ZHOU	DATE	10-6-2024	MATERIAL	
CHECK	T.Y.LI	DATE	10-6-2024	DWG. NO.	TZ\UBC131-A/1.0
APPROVAL	H.Q.ZHOU	DATE	10-6-2024	SHEET	1/1

PART NAME	USB 2.0 TYPE-C (14PIN) CONNECTOR	TOLERANCE UNLESS	0.0±0.35 0.00±0.25	UNIT:	mm
PART NO.	LUB-C131	OTHERWISE SPECIFIED:	0.000±0.15		

F

E

D

C

B

A